



Pani composite cross section

Pani IUP Mineral Resource Estimate:
33% Lion / 67% Merdeka
89.5MT at 0.82g/t Au for 2.37Moz Au¹

Pani Contract of Work Mineral Resource Estimate:
100% J Resources
72.7MT at 0.98g/t Au for 2.30Moz Au²

Unification of 2.37Moz¹ + 2.30Moz² Resources
(to become 40% Merdeka / 40% J Resources / 20% Lion) pending
subject to deal closure / arbitration³

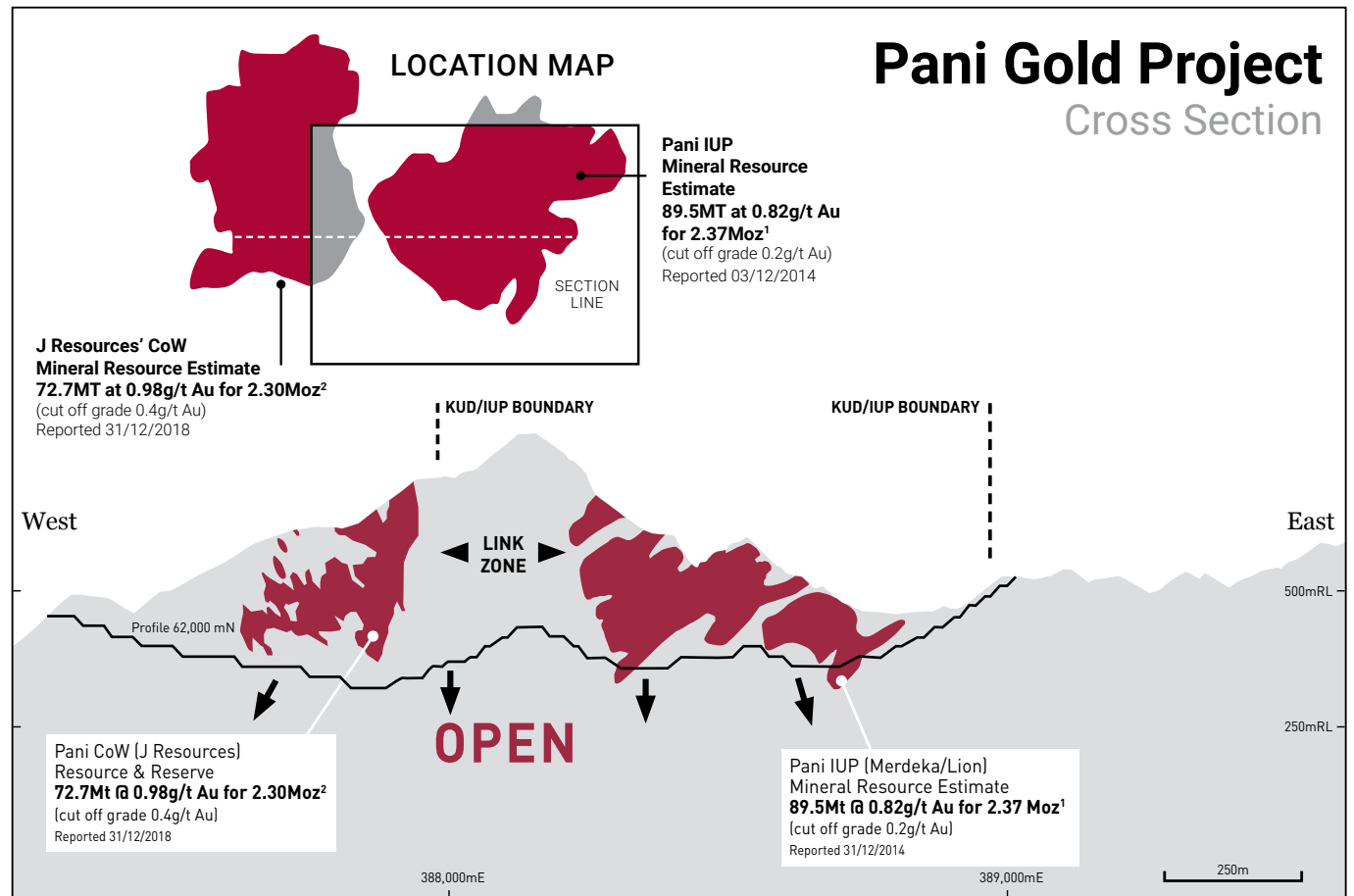

Pani Gold Project looking north

Pani Gold Project

Cross Section

LOCATION MAP

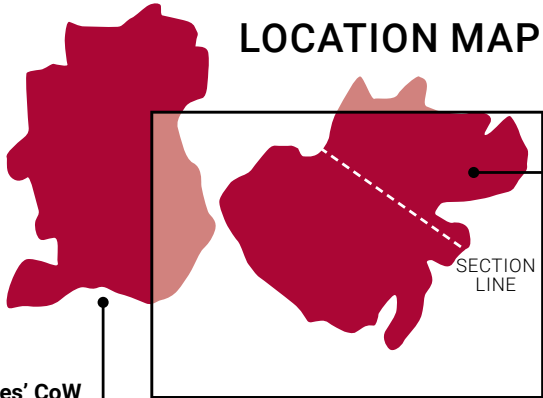

**Pani IUP
Mineral Resource Estimate**
89.5MT at 0.82g/t Au for 2.37Moz¹
 (cut off grade 0.2g/t Au)
 Reported 03/12/2014

**J Resources' CoW
Mineral Resource Estimate**
72.7MT at 0.98g/t Au for 2.30Moz²
 (cut off grade 0.4g/t Au)
 Reported 31/12/2018

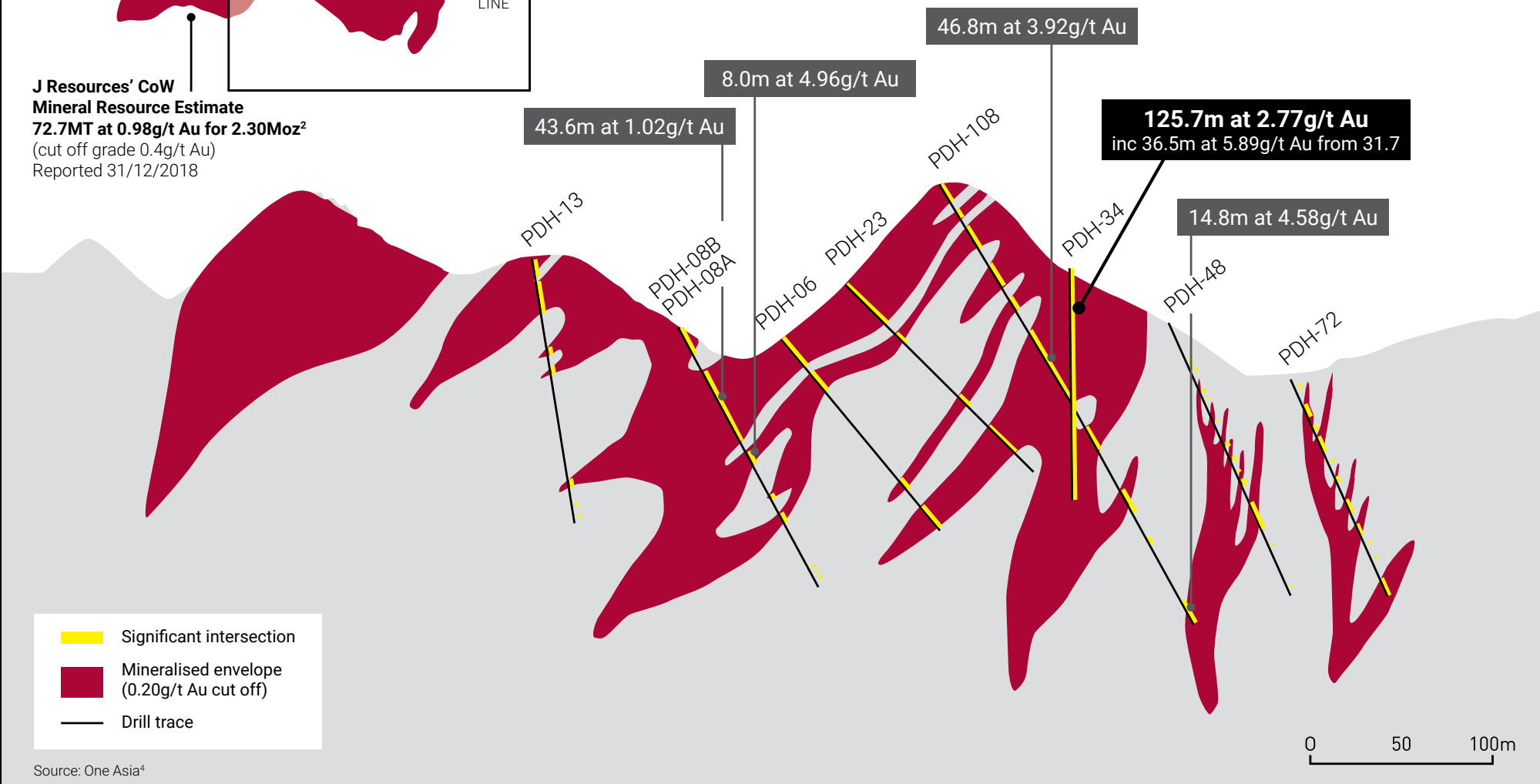

— Significant intersection
█ Mineralised envelope (0.20g/t Au cut off)
— Drill trace

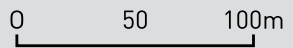

Source: One Asia⁴

Pani Gold Project

Cross Section

LOCATION MAP

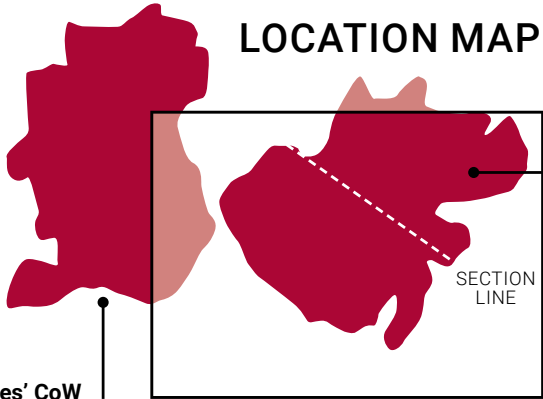

**Pani IUP
Mineral Resource Estimate**
89.5MT at 0.82g/t Au for 2.37Moz¹
 (cut off grade 0.2g/t Au)
 Reported 03/12/2014

**J Resources' CoW
Mineral Resource Estimate**
72.7MT at 0.98g/t Au for 2.30Moz²
 (cut off grade 0.4g/t Au)
 Reported 31/12/2018

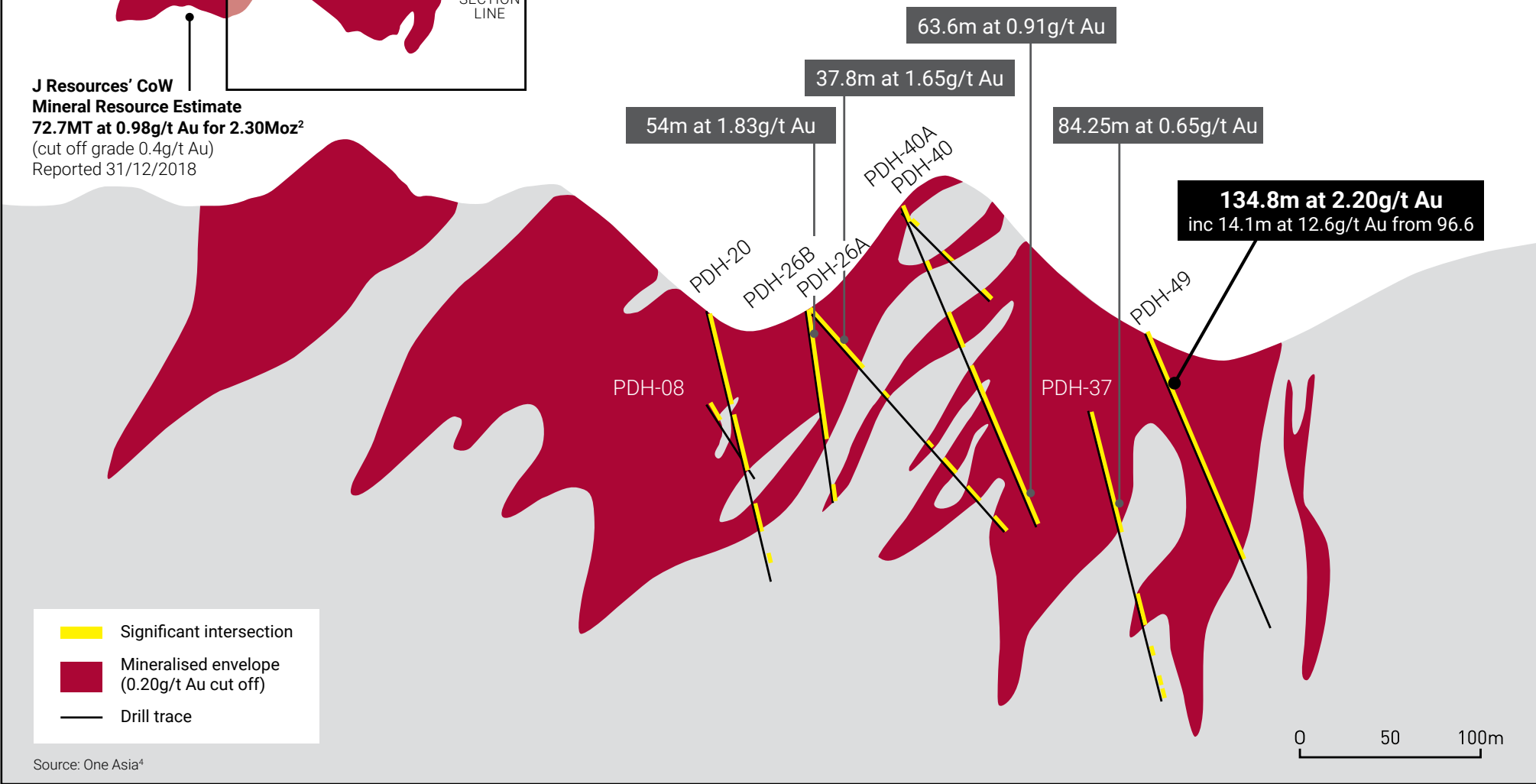

- Significant intersection
- Mineralised envelope (0.20g/t Au cut off)
- Drill trace

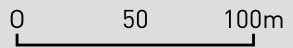

Source: One Asia⁴

Pani Gold Project

Cross Section

LOCATION MAP



Pani IUP
Mineral Resource Estimate
89.5MT at 0.82g/t Au for 2.37Moz¹
 (cut off grade 0.2g/t Au)
 Reported 03/12/2014

J Resources' CoW
Mineral Resource Estimate
72.7MT at 0.98g/t Au for 2.30Moz²
 (cut off grade 0.4g/t Au)
 Reported 31/12/2018

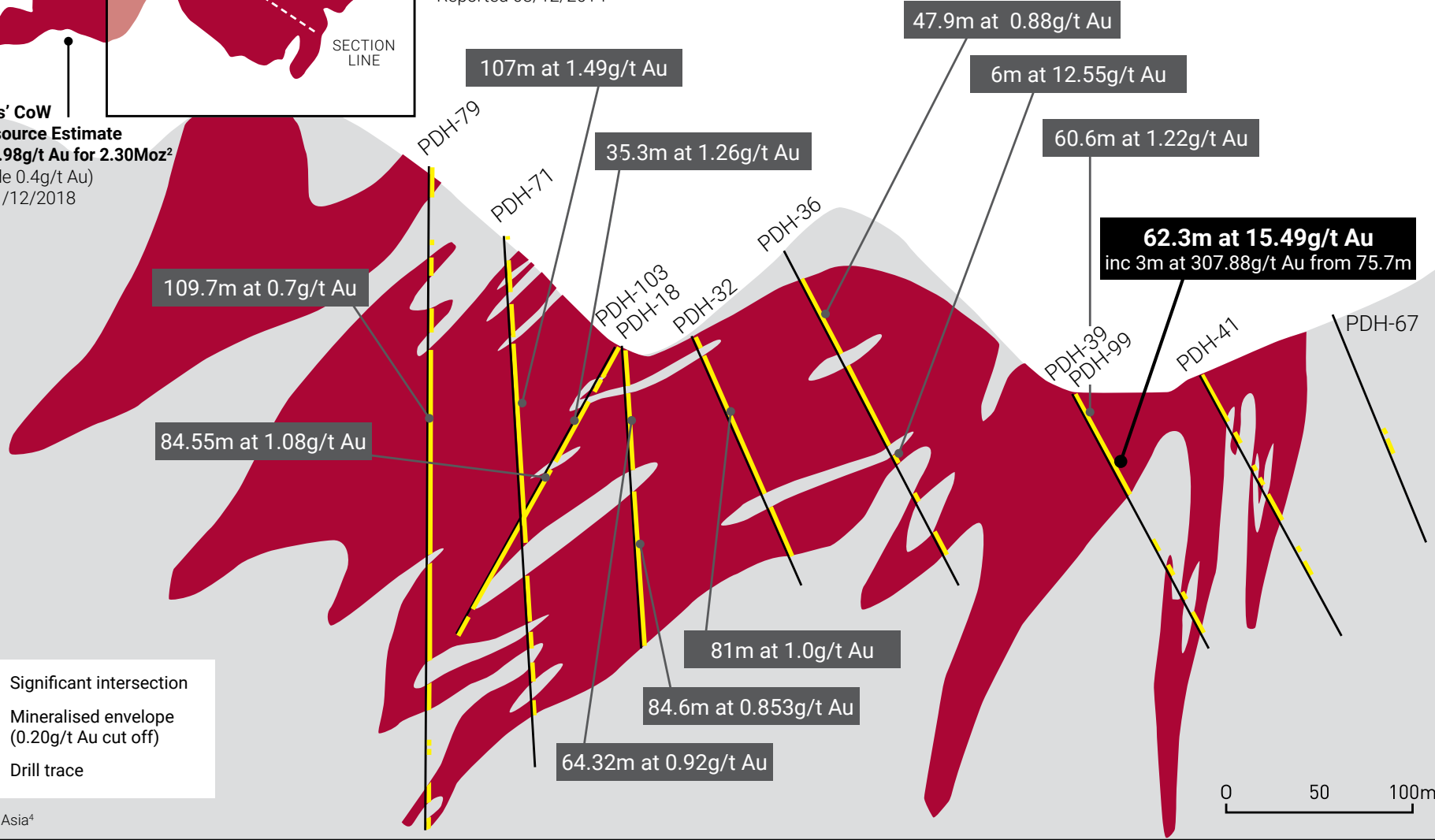

- Significant intersection
- Mineralised envelope (0.20g/t Au cut off)
- Drill trace

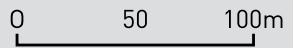

Source: One Asia⁴



Notes:

1. Refer to One Asia Resources Limited news release 3 December 2014 (https://www.oneasiareources.com/images/document/News_Release_Dec_3_2014.pdf).
2. Refer to J Resources 31 December 2018 Annual Report (<http://www.jresources.com/investors/article/final-resources-reserves-compilation-2017-to-2018>)
3. Refer to ASX announcement by Lion Selection Group, 4 February 2021 Pani Arbitration Initiated with J Resources: US\$500-\$600m Compensation Claim
4. Pani geological information extracted from One Asia Resources Technical Report, released in 2014 to support the Pani MRE: https://www.oneasiareources.com/images/document/Pani%20Mineral%20Resource%20Estimation%20Final%20by%20SRK%20122014_inc%20App%20A_F.pdf

